



Features

- Capacity Range: 1 to 55 Ton.
- Robust all steel construction for safe operation.
- Easy to install with minimum headroom.
- Compact size and lightweight.
- Special clamp jaw design distributes load away from edge.
- Threaded screw fits securely on a wide range of flange width and beam sizes.
- Easy to replace parts.

Screw Pin Shackle

- Allows for many creative recoveries.
- Ideal for use with Straps & Chains.
- A MUST for every Gear Bag.

DIMENSIONS & SPECIFICATIONS

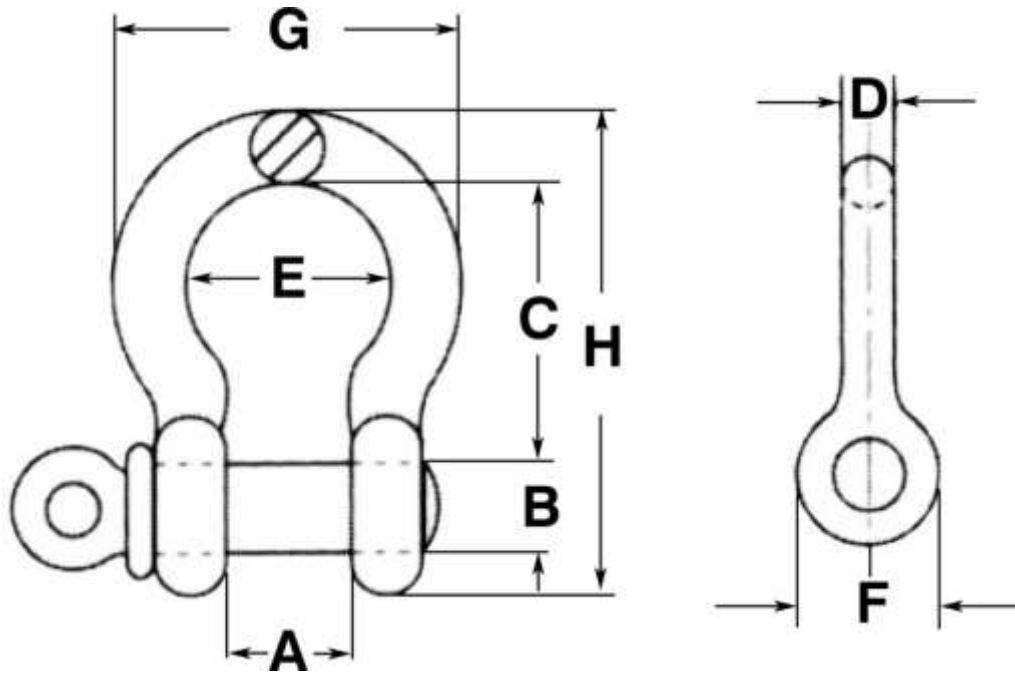

Model	Size (in)	WLL (TON)	A (in)	B (in)	C (in)	D (in)	E (in)	F (in)	G (in)	H (in)	Net Weight (lbs)
SH-0100	3/8	1	0.66	0.44	1.44	0.38	1.03	1.26	1.78	2.49	0.31
SH-0200	1/2	2	0.81	0.63	1.88	0.50	1.31	1.19	2.31	3.28	0.73
SH-0475	3/4	4.75	1.25	0.81	2.81	0.75	2.00	1.81	3.50	4.97	2.36
SH-0950	1 1/8	9.5	1.77	1.44	4.25	1.16	2.91	2.69	5.16	7.47	7.41
SH-1700	1 1/2	17	2.38	2.03	5.75	1.54	3.88	3.63	6.88	10.00	18.00
SH-2500	1 3/4	25	2.87	1.97	6.93	1.82	5.00	4.15	8.77	12.26	27.00
SH-3500	2	35	3.23	2.24	7.76	2.06	5.70	4.77	9.87	13.55	42.00
SH-5500	2 1/2	55	4.09	2.73	10.40	2.68	7.18	5.64	12.75	17.67	86.00

*WLL = Working Load Limit