

Features

- Use the economical PT for applications involving longer traversing distances.
- Capacity range from 0.25 to 20 ton
- Easily Adjustable to fit a wide range of beam widths simply by adjusting the number of collars.
- Anti-friction precision type ball bearings.
- High grade sealed ball bearings with a minimum B10 bearing life of 3,000 hours.
- Standard anti-tilt and anti-drop devices
- Forged steel wheels hardened to a minimum of 425 Brinell are made to fit any shape of the beam.
- Light weight robust construction.
- Double row bearings with combination radial and thrust.
- Easy to install with minimum headroom.
- Simplified part replacement.
- Minimum maintenance.
- Flange Width can be customized to fit almost any beam. (Fee may apply for modification, please contact ACI for further information.)



Trolley Design

Adjustable to fit standard or wide flange I-beam tracks, this beam trolley allows you to move with a simple push! The dual wheels are designed for a straight or tapered beam track and work on both straight and curved tracks. The contoured wheels ensure reliable tracking, and sealed ball bearings avoid maintenance hassles and provide smooth operation. Featuring a durable powder coat finish and pre-lubricated sealed bearings to withstand heavy use, this beam trolley is an ideal material handling tool for warehouses, garages and other industrial areas.

Push Trolleys

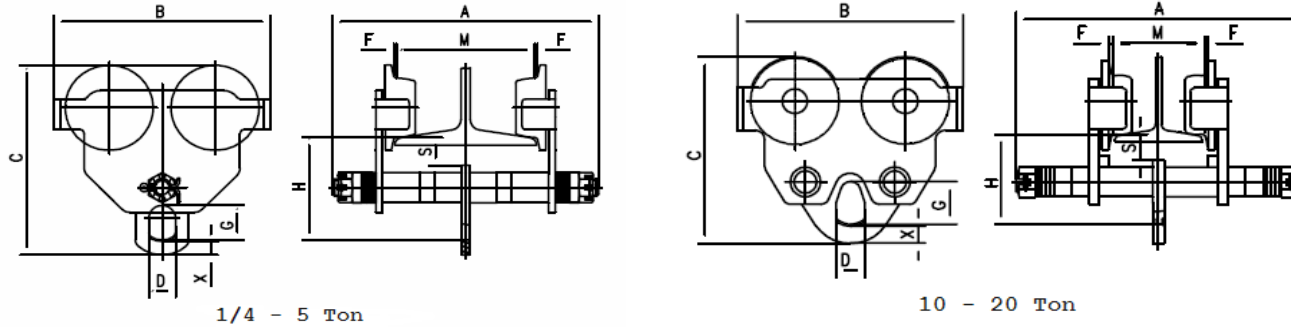

PUSH TROLLEY SPECIFICATIONS

Model	PT-005-S	PT-010-S	PT-020-S	PT-040-S	PT-060-S	PT-060-L	PT-100-S	PT-100-L	PT-200-L	PT-400-L	
Rated Capacity (tons)	¼	½	1	2	3	3	5	5	10	20	
Min. radius of curve (ft.)	2.6	2.6	3.3	3.6	4.3	4.3	4.6	4.6	6.6	11.5	
Diameter of wheel (in.)	2.3	2.3	2.9	3.5	4.3	4.3	4.8	4.8	5.9	7.9	
Dimensions (in.)	A	9.6	9.6	12.2	12.9	13.5	17.5	14	18	20.1	23.8
	B	7.6	7.6	9.7	10.9	13.1	13.1	14.8	14.8	16.7	23.8
	C	7.4	7.4	8.7	10.3	12.2	12.2	13.9	13.9	15.6	19.6
	H	4.1	4.1	4.9	5.9	6.7	6.7	7.7	7.7	7.5	9.2
	S	1.2	1.2	1.5	1.5	1.6	1.6	1.7	1.7	1.8	2.3
	D	1	1	1.2	1.5	1.6	1.6	2	2	2.8	3.7
	X	0.63	0.63	0.63	0.75	0.88	0.88	1.13	1.13	2	3.5
	G	1.3	1.3	1.6	2	2.5	2.5	3	3	4.3	5.3
F	0.10 - 0.12								0.10 - 0.14		
I-beam width range (in.)	M	2.0 - 6.0	2.0 - 6.0	2.5 - 8.0	3.5 - 8.0	4.0 - 8.0	4.0 - 12.0	4.5 - 8.0	4.5 - 12.0	4.9 - 12.0	5.4 - 12.0
Net weight (lbs.)		15.4	15.4	26.5	48.5	66	70	95	100	205	518

** Flange Width can be customized to fit almost any beam. (Fee may apply for modification)

Push Trolleys

Model: PT

PT-0214

2721 NE 4th Ave Pompano FL 33064 | 1-888-4-A-HOIST