



Unique hand chain wheel cover allows hoist operation from any angle

Fully machined lift wheel and fully enclosed gear train

ISO high grade alloy load chain

ACI Hand Chain Hoists are compact and lightweight with low headroom—for easy installation and operation.

Product Features:

- Available in capacities from ½ to 20 tons.
- Lightweight, robust construction.
- One piece suspension frame.
- Hoist is geared to allow lowest effort to lift maximum loads.
- Fully forged swivel hooks are fitted with hook safety latches as standard.
- Automatic double pawl braking system, screw and disc type load brakes.
- Double cover protection. Anti-friction ball bearings.
- Zinc plated hand chain included as standard.
- Each hoist is proof tested at 1.5 times of WLL. Slip clutch type load limiting device.

Hoist Information

This hand chain hoist is an efficient means of lifting freely suspended material loads within its load rating. The frame and covers of the hoist are constructed of durable stamped steel.

The cast hand chain wheel and load actuated brake are designed to provide smooth and precise spotting of loads.

Hand Chain Hoists

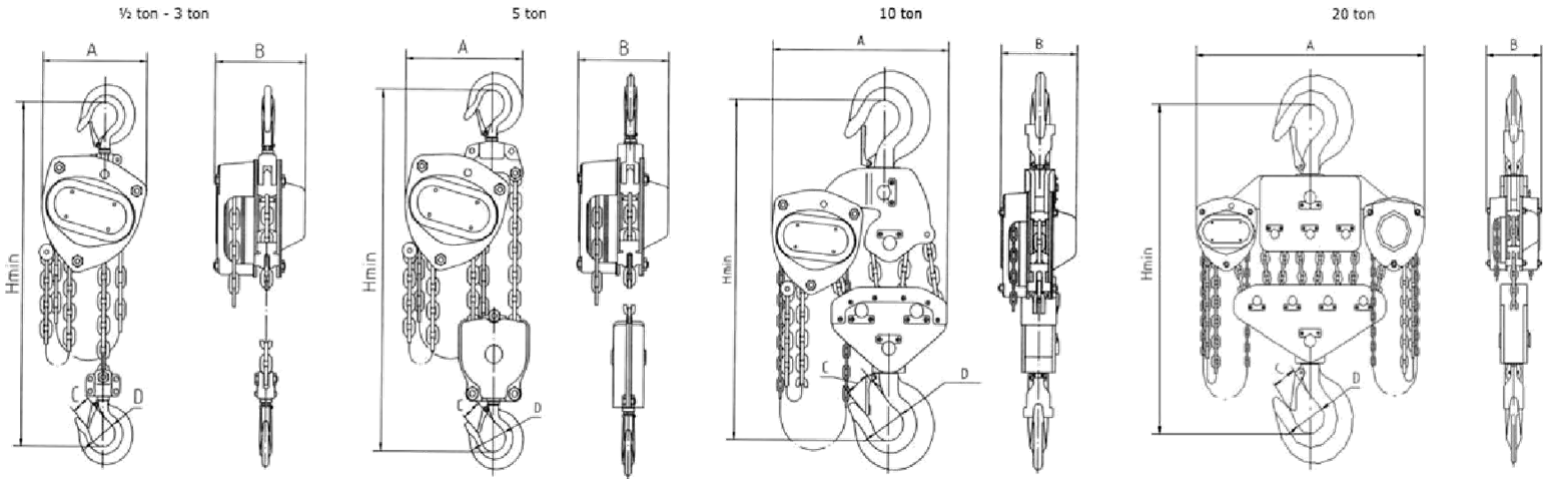

CHAIN HOIST SPECIFICATION (Table 1)

Model	HCH-010	HCH-020	HCH-040	HCH-060	HCH-100	HCH-200	HCH-400	
Capacity (ton)	1/2	1	2	3	5	10	20	
No. of load chain falls	1	1	1	1	2	4	8	
Chain wire diameter (in)	.20	.24	.32	.39	.35	.35	.35	
Hand pull chain rated load (lbs)	54	56	75	84	81	86	86	
Distance (in)	A	5.8	6.8	8.3	10.0	11.0	18.2	35.4
	B	5.2	6	6.9	8.1	7.4	7.4	7.4
	C	0.98	1.06	1.40	1.54	1.77	2.13	3.15
	D	1.24	1.48	1.97	2.17	2.60	3.35	4.17
	H	13.58	14.80	18.50	21.57	27.10	30.11	37.40
Net weight including 10 ft lift/8 ft hand chain (lbs)	24.3	27.5	43.8	77.2	91.1	173.1	419.0	
Extra weight per foot extra lift chain (lbs)	0.98	1.14	1.61	2.28	3.29	5.51	10.08	
Extra weight per foot extra hand chain (lbs)	.60	.60	.60	.60	.60	.60	.60	