



## SCREW PIN SHACKLE

Model SH



### Features

- RRC-271D Type IVA, Grade A Class 2.
- Shackles meet or exceed Federal Specification RRC-271D.
- Working Load Limit and Traceability codes shown as permanent marking on body and pin.
- Available in painted, galvanized and self-colored finishes (Dacromate coating upon special request only).
- Special products engineering available to fit your special lifting, tie down and pulling needs.

### Screw Pin Shackle

- Allows for many creative recoveries.
- Ideal for use with Straps & Chains.
- A MUST for every Gear Bag.
- From 1 to 17 ton.



689 S.W. 7<sup>th</sup> Terrace  
Dania, FL 33004  
Phone: (964) 367-6116  
info@acihoist.com

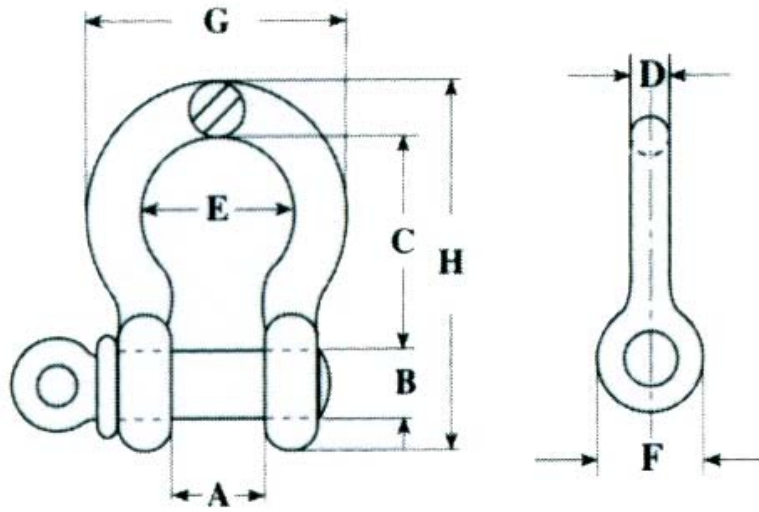

SIZE Inch	WLL Ton	A in	B in	C in	D in	E in	F in	G in	H in	N. W lb
3/16	0.33	0.38	0.25	0.88	0.19	0.60	0.56	0.98	1.47	0.07
1/4	0.5	0.47	0.31	1.13	0.25	0.78	0.61	1.28	1.84	0.11
5/16	0.75	0.53	0.38	1.22	0.31	0.84	0.75	1.47	2.09	0.20
3/8	1.0	0.66	0.44	1.44	0.38	1.03	1.26	1.78	2.49	0.31
7/16	1.5	0.75	0.50	1.69	0.44	1.16	1.06	2.03	2.91	0.37
1/2	2.0	0.81	0.63	1.88	0.50	1.31	1.19	2.31	3.28	0.73
5/8	3.25	1.06	0.75	2.38	0.63	1.69	1.50	2.93	4.19	1.37
3/4	4.75	1.25	0.81	2.81	0.75	2.00	1.81	3.50	4.97	2.36
7/8	6.5	1.44	1.06	3.31	0.88	2.28	2.09	4.03	5.83	3.62
1	8.5	1.69	1.25	3.75	1.00	2.69	2.38	4.69	6.56	5.03
1 1/8	9.5	1.77	1.44	4.25	1.16	2.91	2.69	5.16	7.47	7.41
1 1/4	12.0	2.03	1.69	4.69	1.29	3.25	3.00	5.75	8.25	9.50
1 3/8	13.5	2.25	1.77	5.25	1.42	3.63	3.31	6.38	9.14	13.54
1 1/2	17.0	2.38	2.03	5.75	1.54	3.88	3.63	6.88	10.00	17.20
1 3/4	25.0	2.88	2.00	7.00	1.84	5.00	4.19	8.86	12.38	27.78
2	35.0	3.25	2.25	7.74	2.08	5.75	4.81	9.97	13.68	45.00
2 1/2	55.0	4.13	2.75	10.50	2.71	7.25	5.69	12.87	17.84	85.76

SIZE Inch	WLL Ton	A in	B in	C in	D in	E in	F in	G in	H in	N. W lb	Miami Cordage	C&M Prices	Crosby Prices
3/16	0.33	0.38	0.25	0.88	0.19	0.60	0.56	0.98	1.47	0.07	N/A	N/A	N/A
1/4	0.5	0.47	0.31	1.13	0.25	0.78	0.61	1.28	1.84	0.11	N/A	N/A	N/A
5/16	0.75	0.53	0.38	1.22	0.31	0.84	0.75	1.47	2.09	0.20	N/A	N/A	N/A
3/8	1.0	0.66	0.44	1.44	0.38	1.03	1.26	1.78	2.49	0.31	\$1.50	\$6.63	\$5.90
7/16	1.5	0.75	0.50	1.69	0.44	1.16	1.06	2.03	2.91	0.37	N/A	N/A	N/A
1/2	2.0	0.81	0.63	1.88	0.50	1.31	1.19	2.31	3.28	0.73	\$2.95	\$9.06	\$7.90
5/8	3.25	1.06	0.75	2.38	0.63	1.69	1.50	2.93	4.19	1.37	N/A	N/A	N/A
3/4	4.75	1.25	0.81	2.81	0.75	2.00	1.81	3.50	4.97	2.36	\$6.50	\$24.08	\$21.44
7/8	6.5	1.44	1.06	3.31	0.88	2.28	2.09	4.03	5.83	3.62	N/A	N/A	N/A
1	8.5	1.69	1.25	3.75	1.00	2.69	2.38	4.69	6.56	5.03	N/A	N/A	N/A
1 1/8	9.5	1.77	1.44	4.25	1.16	2.91	2.69	5.16	7.47	7.41	\$17.50	\$65.20	\$58.00
1 1/4	12.0	2.03	1.69	4.69	1.29	3.25	3.00	5.75	8.25	9.50	N/A	N/A	N/A
1 3/8	13.5	2.25	1.77	5.25	1.44	3.63	3.31	6.38	9.14	13.54	N/A	N/A	N/A
1 1/2	17.0	2.38	2.00	5.75	1.54	3.83	3.63	6.88	10.00	17.20	\$45.63	\$143.25	\$127.70
1 3/4	25.0	2.88	2.00	7.00	1.84	5.09	4.19	8.86	12.38	27.78	N/A	N/A	N/A
2	35.0	3.25	2.25	7.74	2.00	5.75	4.81	9.97	13.68	45.00	N/A	N/A	N/A
2 1/2	55.0	4.13	2.75	10.50	2.71	7.25	5.69	12.87	17.84	85.76	N/A	N/A	N/A