

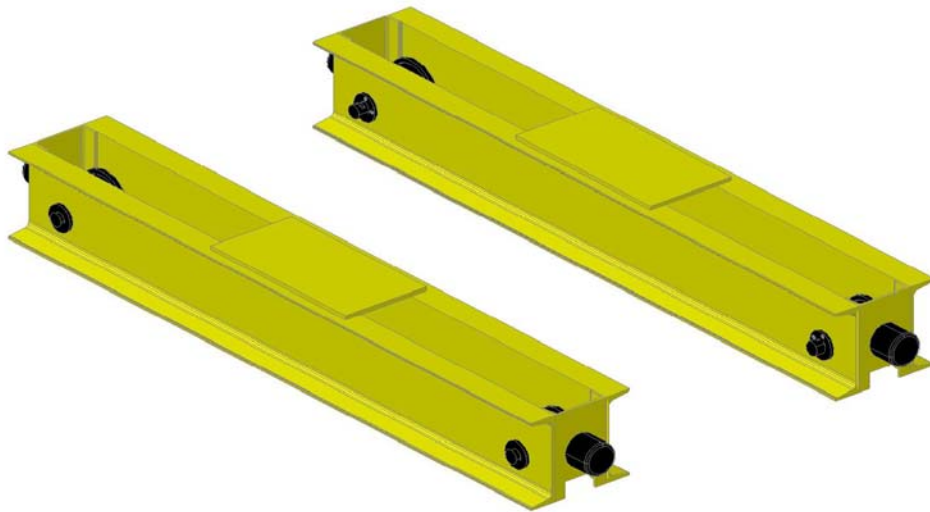

End Trucks

T
O
P

R
U
N
N
G



689 S.W. 7th Terrace
Dania, FL 33004
Phone (954) 367-6116
Fax (954) 272-0334
www.ACIHoist.com

Top Running End Truck Pushed & Motorized

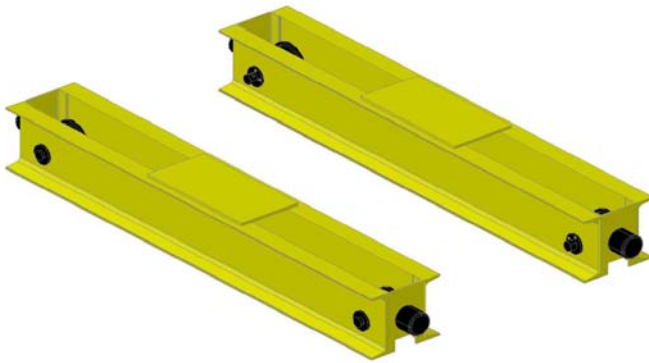

Features

- Capacity up to 5 ton
- Standard truck wheelbase 4 ft to 7.5 ft.
- Bridge span up to 60 feet. High impact rubber bumpers and bridge brakes are provided as standard.
- Push type or motorized type end trucks
- Minimum recommended rail is ASCE20#
- Wheel bearings are lifetime-lubricated precision ball bearings
- Custom designs available for longer spans.
- It will fit American Standard S and W beams.

End Truck Construction

End truck frames are constructed from steel channels which provide superior strength, rigidity and structural integrity.

The wheel base meets the CMAA span to wheel base ratio limit of 8 to 1. Wheel diameters are from 5" to 10", with a hardness of 350 BHN.

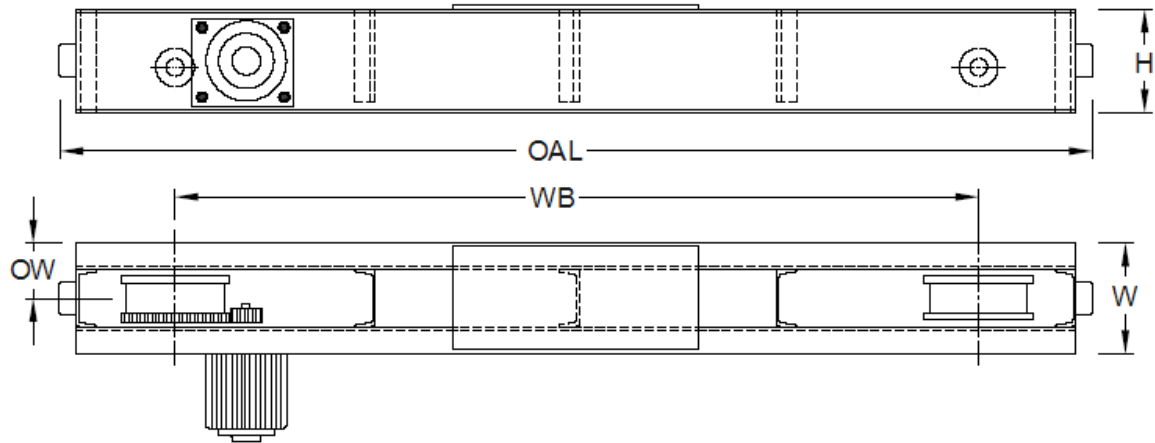

ETTM-Top Running Motorized End Truck: *Dimensions*

Cap (tons)	Model	Wheel Ø (in)	Max Span (ft)	Wheel base (WB) (ft)	Overall length (OAL) (in)	Height (H) (in)	Width (W) (in)	Width (OW) (in)
3	ETTM060070-032	5	32	4	62			
	ETTM060140-032							
	ETTM060070-040		40	5	74			
	ETTM060140-040							
	ETTM060070-048		48	6	86			
	ETTM060140-048							
	ETTM060070-056		56	7	98			
	ETTM060140-056							
ETTM060070-060	60	7.5	104					
ETTM060140-060								
5	ETTM100070-032	6	32	4	62			
	ETTM100140-032							
	ETTM100070-040		40	5	75			
	ETTM100140-040							
	ETTM100070-048		48	6	87			
	ETTM100140-048							
	ETTM100070-056		56	7	99			
	ETTM100140-056							
ETTM100070-060	60	7.5	105					
ETTM100140-060								
10	ETTM200070-032	8	32	4	65			
	ETTM200140-032							
	ETTM200070-036		36	4.5	71			
	ETTM200140-036							
	ETTM200070-040		40	5	77			
	ETTM200140-040							
	ETTM200070-044		44	5.5	83			
	ETTM200140-044							
	ETTM200070-048		48	6	89			
	ETTM200140-048							
	ETTM200070-052		52	6.5	95			
	ETTM200140-052							
ETTM200070-056	56	7	101					
ETTM200140-056								
ETTM200070-060	60	7.5	107					
ETTM200140-060								

Cap (tons)	Model	Wheel Ø (in)	Max Span (ft)	Wheel base (WB) (ft)	Overall length (OAL) (in)	Height (H) (in)	Width (W) (in)	Width (OW) (in)
15	ETTM300070-024	10	24	3	57	12.4	11.9	5.6
	ETTM300140-024							
	ETTM300070-028		28	3.5	63			
	ETTM300140-028							
	ETTM300070-032		32	4	69			
	ETTM300140-032							
	ETTM300070-036		36	4.5	75			
	ETTM300140-036							
	ETTM300070-040		40	5	81			
	ETTM300140-040							
	ETTM300070-044		44	5.5	87			
	ETTM300140-044							
	ETTM300070-048		48	6	93			
	ETTM300140-048							
	ETTM300070-052		52	6.5	99			
	ETTM300140-052							
ETTM300070-056	56	7	105					
ETTM300140-056								
ETTM300070-060	60	7.5	111					
ETTM300140-060								

*Other capacities, wheel sizes and spans are available upon request.

ETTM-Top Running Motorized End Truck: *Specifications*

Cap (tons)	Model	Wheel Ø (in)	Max Speed travel (ft/min)	Drive (Hp)	Recommended Rail size (ASCE #)	Shipping weight set (lb)
3	ETTM060070-024	5	70	1	25	463
	ETTM060140-024		140	2		483
	ETTM060070-028		70	1		488
	ETTM060140-028		140	2		508
	ETTM060070-032		70	1		513
	ETTM060140-032		140	2		533
	ETTM060070-036		70	1		539
	ETTM060140-036		140	2		558
	ETTM060070-040		70	1		564
	ETTM060140-040		140	2		584
	ETTM060070-044		70	1		589
	ETTM060140-044		140	2		609
	ETTM060070-048		70	1		634
	ETTM060140-048		140	2		654
	ETTM060070-052		70	1		660
	ETTM060140-052		140	2		679
ETTM060070-056	70	1	685			
ETTM060140-056	140	2	704			
ETTM060070-060	70	1	710			
ETTM060140-060	140	2	730			
5	ETTM100070-024	6	70	1	30	514
	ETTM100140-024		140	2		534
	ETTM100070-028		70	1		540
	ETTM100140-028		140	2		559
	ETTM100070-032		70	1		565
	ETTM100140-032		140	2		585
	ETTM100070-036		70	1		590
	ETTM100140-036		140	2		610
	ETTM100070-040		70	1		616
	ETTM100140-040		140	2		635
	ETTM100070-044		70	1		641
	ETTM100140-044		140	2		661
	ETTM100070-048		70	1		686
	ETTM100140-048		140	2		706
	ETTM100070-052		70	1		711
	ETTM100140-052		140	2		731
ETTM100070-056	70	1	736			
ETTM100140-056	140	2	756			
ETTM100070-060	70	1	762			
ETTM100140-060	140	2	782			
10	ETTM200070-024	8	70	2	40	797
	ETTM200140-024		140	3		922
	ETTM200070-028		70	2		831
	ETTM200140-028		140	3		957
	ETTM200070-032		70	2		865
	ETTM200140-032		140	3		990
	ETTM200070-036		70	2		898
	ETTM200140-036		140	3		1024
	ETTM200070-040		70	2		932
	ETTM200140-040		140	3		1058
	ETTM200070-044		70	2		965
	ETTM200140-044		140	3		1091
	ETTM200070-048		70	2		1029
	ETTM200140-048		140	3		1155
	ETTM200070-052		70	2		1063
	ETTM200140-052		140	3		1189
ETTM200070-056	70	2	1096			
ETTM200140-056	140	3	1222			
ETTM200070-060	70	2	1130			
ETTM200140-060	140	3	1256			

Cap (tons)	Model	Wheel Ø (in)	Max Speed travel (ft/min)	Drive (Hp)	Recommended Rail size (ASCE #)	Shipping weight set (lb)
15	ETTM300070-024	10	70	2	60	1270
	ETTM300140-024		140	5		1292
	ETTM300070-028		70	2		1315
	ETTM300140-028		140	5		1337
	ETTM300070-032		70	2		1361
	ETTM300140-032		140	5		1383
	ETTM300070-036		70	2		1406
	ETTM300140-036		140	5		1430
	ETTM300070-040		70	2		1452
	ETTM300140-040		140	5		1474
	ETTM300070-044		70	2		1498
	ETTM300140-044		140	5		1520
	ETTM300070-048		70	2		1579
	ETTM300140-048		140	5		1600
	ETTM300070-052		70	2		1624
	ETTM300140-052		140	5		1646
	ETTM300070-056		70	2		1670
	ETTM300140-056		140	5		1692
ETTM300070-060	70	2	1716			
ETTM300140-060	140	5	1738			

*The weight does not include the control box.

*All of our end trucks are delivered in primer coat. For epoxy blue or yellow color please contact the factory.

* We do not recommend single speed motor above 90 fpm.

* General specifications and dimensions might vary depending on your specific needs.

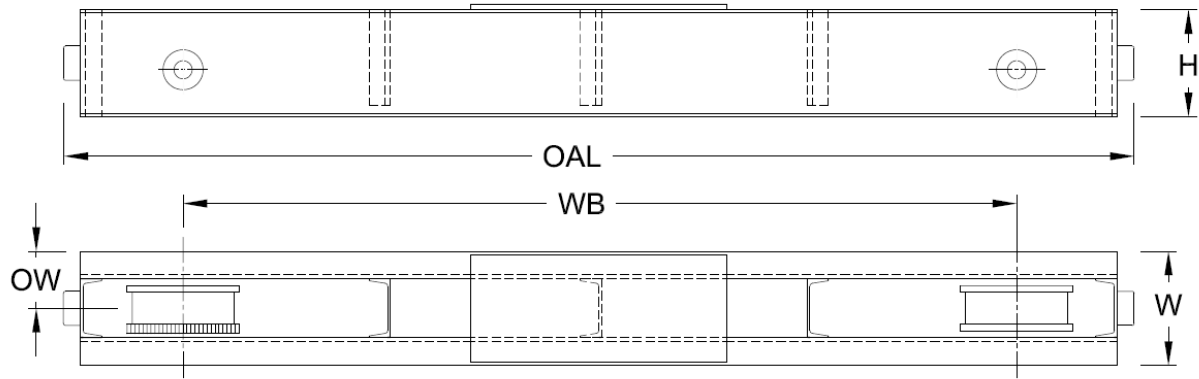

ETTP-Top Running Push End Truck - Dimensions and Specifications -

Cap (tons)	Model	Wheel Ø (in)	Max Span (ft)	Wheel base (WB) (ft)	Overall length (OAL) (in)	Height (H) (in)	Width (W) (in)	Width (OW) (in)	Recommended Rail size (ASCE #)	Shipping weight set (lb)
3	ETTP060-024	5	24	3	50	8.4	9.7	4.6	25	360
	ETTP060-032		32	4	62					360
	ETTP060-036		36	4.5	68					380
	ETTP060-040		40	5	74					404
	ETTP060-048		48	6	86					464
	ETTP060-060		60	7.5	104					528
5	ETTP100-032	6	32	4	50	8.4	9.7	4.6	25	451
	ETTP100-040		40	5	74					501
	ETTP100-048		48	6	86					570
	ETTP100-060		60	7.5	104					646

*Other capacities, wheel sizes and spans are available upon request.

*All of our end trucks are delivered in primer coat. For epoxy blue or yellow color please contact the factory.

*General specifications and dimensions might vary depending on your specific needs.